

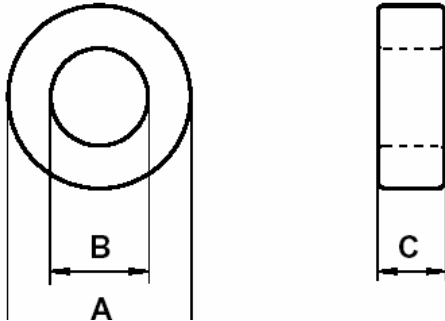

# 0077110A7

110 Delta Drive  
 Pittsburgh, PA 15238  
 Phone: 412/696-1333  
 Fax: 412/696-0333  
 Email:magnetics@spang.com



### Core Markings

XXXXXX lot number  
 77110A7 part number  
 X inductance

DIMENSIONS		
(mm)	Uncoated	Coated
O.D. (A)	57.2	58.0
I.D. (B)	35.6	34.7
Ht. (C)	14.0	14.86

PHYSICAL CHARACTERISTICS					
W <sub>A</sub> Window Area	A <sub>e</sub> Cross Section	L <sub>e</sub> Path Length	V <sub>e</sub> Volume	Weight	Box Quantity
948.0 mm <sup>2</sup>	144.4 mm <sup>2</sup>	143.0 mm	20,650 mm <sup>3</sup>	127 grams	90 pieces

Typical AL Values Core: 0077110A7

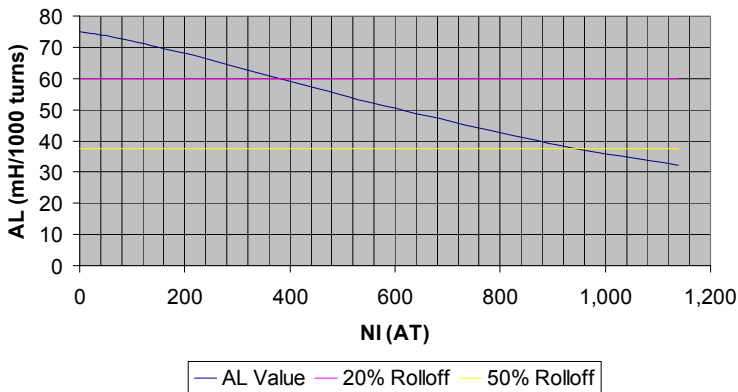

Permeability ( $\mu$ )      60

A<sub>L</sub> ± 8%                      75

Winding Turn Length	
Winding Factor	Length/Turn (cm)
100% (Unity)	9.33
60%	7.76
40%	6.23
20%	5.56
0%	5.30

Wound Coil Dimensions	
Maximum O.D. (u.w.f.)*	81.3 mm
Maximum HT. (u.w.f.)*	44.4 mm

\*u.w.f. – unity winding factor

Surface Area	
Unwound Core	76.8 cm <sup>2</sup>
40% Winding Factor	130.7 cm <sup>2</sup>

AWG Wire Size	Single Layer Turns	Single Layer Rdc (Ohms, $\Omega$ )	AWG Wire Size	Single Layer Turns	Single Layer Rdc (Ohms, $\Omega$ )
8	29	0.00318	18	96	0.107
9	33	0.00453	19	108	0.152
10	37	0.00644	20	120	0.211
11	42	0.0092	21	135	0.3
12	48	0.0133	22	152	0.428
13	54	0.0188	23	169	0.596
14	60	0.0263	24	189	0.845
15	68	0.0376	25	212	1.19
16	76	0.0531	26	237	1.69
17	85	0.0746	27	263	2.35