



SPECIFICATION FOR LED DISPLAY

PART NO. : LA(C)3071-13LEWRN

0.3”(7.62mm) SINGLE DIGIT DISPLAY

Approved by: *Daniel Chen* Prepared by: *Tammy*

LEDTECH ELECTRONICS CORPORATION

*5TH FL,NO.542-5,CHUNG CHENG ROAD,
HSIN-TIEN CITY,TAIWAN.*

TEL : 886-2-22186891

FAX : 886-2-22181222,22182894



0.3”(7.62mm) SINGLE DIGIT DISPLAY

PART NO. : LA(C)3071-13LEWRN

Page : 1/5

Features

- * 0.3-INCH (7.62-mm) DIGIT HEIGHT.
- * LOW CURRENT REQUIREMENTS.
- * EXCELLENT CHARACTERS APPEARANCE.
- * WIDE VIEWING ANGLE.
- * SOLID STATE RELIABILITY.
- * I.C. COMPATIBLE.
- * CATEGORIZED FOR LUMINOUS INTENSITY.

Description

The LA(C)3071-13L is a 0.3-inch (7.62-mm) digit height single digit seven-segment display. The super bright red LED chips , which are made from AlGaAs on a transparent GaAs substrate. The device has a grey face and white segments.

Part No.	Led Chip		Description
	Material	Emitting Color	
LA3071-13LEWRN	GaAlAs	Super bright Red	Common Anode
LC3071-13LEWRN			Common Cathode



0.3"(7.62mm) SINGLE DIGIT DISPLAY

PART NO. : LA(C)3071-13LEWRN

Page : 2/5

Package Dimensions

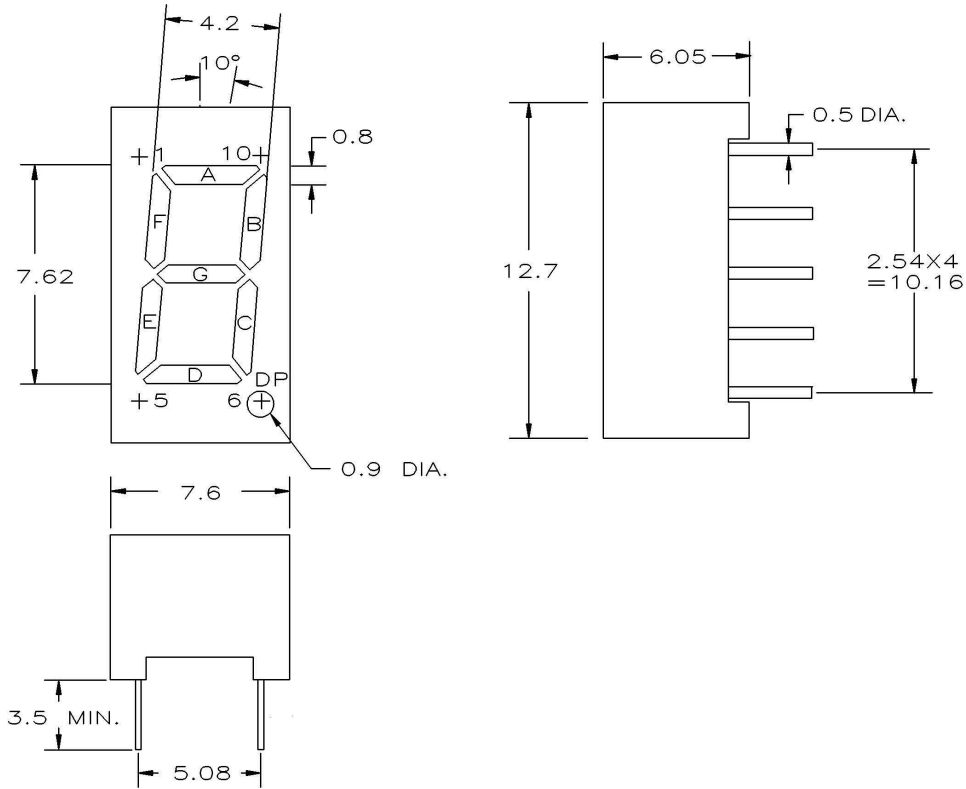

1. ALL DIMENSIONS ARE IN mm, TOLERANCE IS ± 0.15 mm UNLESS OTHERWISE NOTED.
2. THE SLOPE ANGLE OF ANY PIN MAY BE $\pm 5.0^\circ$ MAX.

Internal Circuit Diagram

LA3071-13L

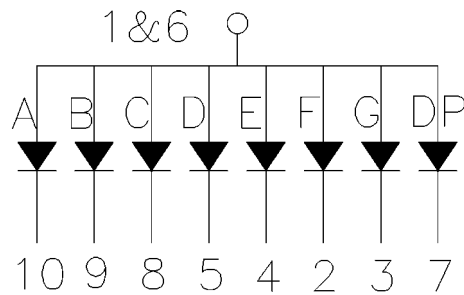

LC3071-13L

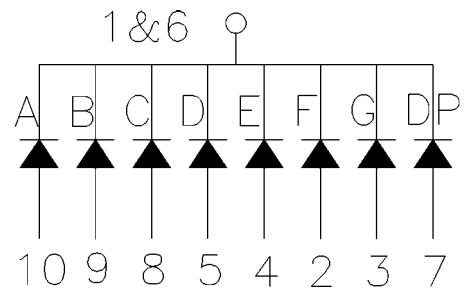



0.3”(7.62mm) SINGLE DIGIT DISPLAY

PART NO. : LA(C)3071-13LEWRN

Page : 3/5

Pin Function

LA3071-13L

Pin No.	Function
1	COMMON ANODE
2	CATHODE F
3	CATHODE G
4	CATHODE E
5	CATHODE D
6	COMMON ANODE
7	CATHODE DP
8	CATHODE C
9	CATHODE B
10	CATHODE A

LC3071-13L

Pin No.	Function
1	COMMON CATHODE
2	ANODE F
3	ANODE G
4	ANODE E
5	ANODE D
6	COMMON CATHODE
7	ANODE DP
8	ANODE C
9	ANODE B
10	ANODE A



0.3”(7.62mm) SINGLE DIGIT DISPLAY

PART NO. : LA(C)3071-13LEWRN

Page : 4/5

Absolute Maximum Ratings at Ta=25°C :

Parameter	Symbol	Rating	Unit
Reverse Voltage Per Led Chip	Vr	4	V
D.C. Forward Current Per Led Chip	If	30	mA
Pulse Current Per Led Chip (1/10 Duty Cycle, 0.1 ms Pulse Width)	If (Peak)	100	mA
Operating Temperature Range	Topr	-25 to +85	°C
Storage Temperature Range	Tstg	-25 to +100	°C
Lead Soldering Temp. (1.6mm from seating plane) for 3 seconds		260	°C

Electrical and Optical Characteristics :

Parameter	Symbol	Condition	Min.	Typ.	Max.	Unit
Luminous Intensity	Iv	If=2mA	1.8	3.2		mcd
Forward Voltage Per Segment	Vf	If=20mA		1.7	2.2	V
Peak Wavelength	λp	If=20mA		660		nm
Dominant Wavelength	λd	If=20mA		643		nm
Reverse Current Per Segment	Ir	Vr=4V			100	μA
Spectrum Line Halfwidth	$\Delta \lambda$	If=20mA		20		nm



0.3”(7.62mm) SINGLE DIGIT DISPLAY

PART NO. : LA(C)3071-13LEWRN

Typical Electrical / Optical Characteristics Curves :

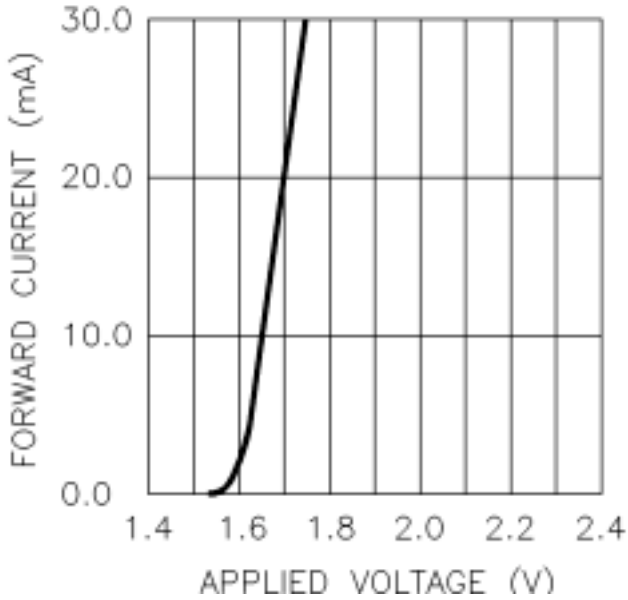

Forward Current vs. Applied Voltage

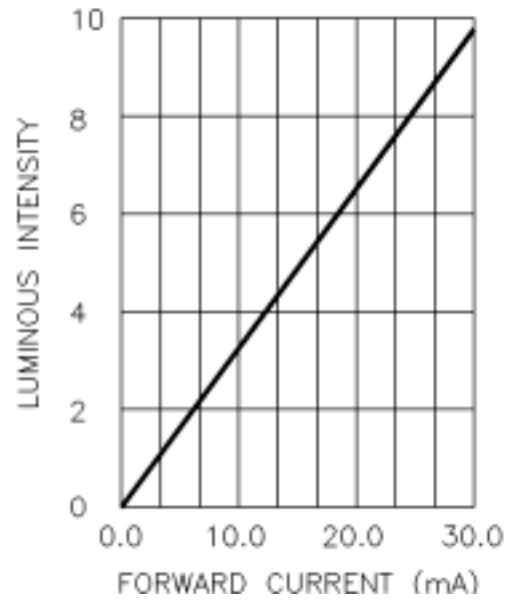

Luminous Intensity vs. Forward Current

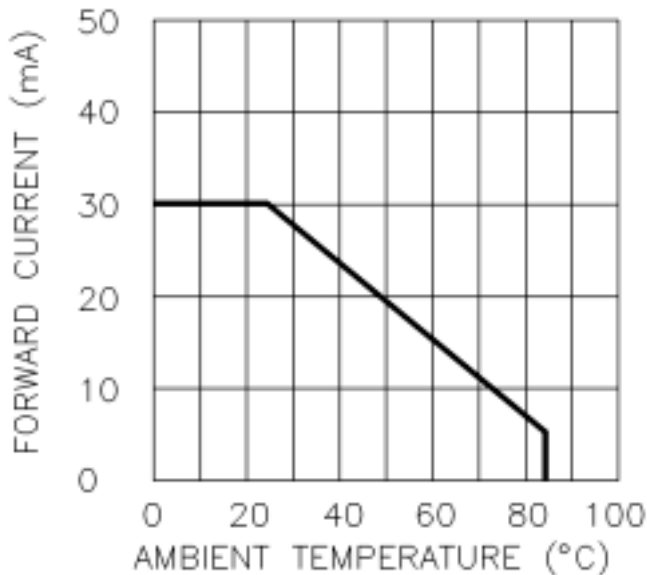

Forward Current vs. Ambient Temperature

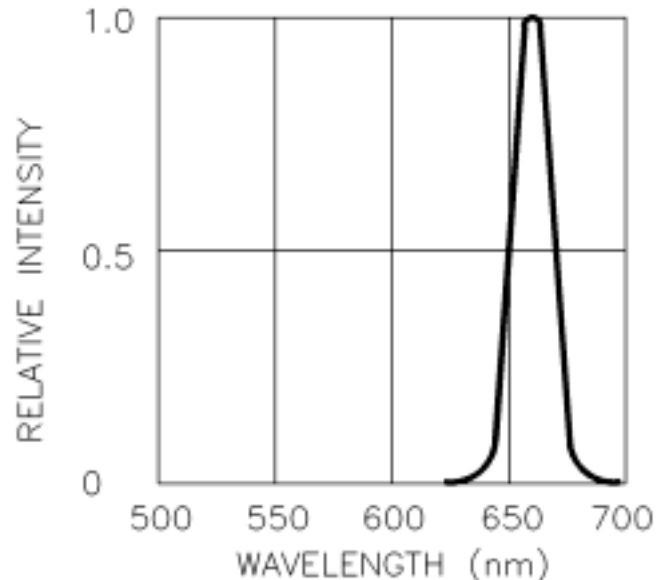

Relative Intensity vs. Wavelength