

# Low-Profile-I.C. Socket

## SCS SERIES SCL SERIES

### Specification:

- Current Rating: 1A min.
- Contact Resistance: Tin Plate 20MΩ  
Gold Plated 10MΩ max.
- Insulation Resistance: 5000MΩ min. 500VDC.
- Operating Temperature: Continuous -55°C + 85°C
- Withstanding Voltage: AC 1000V (1 min).
- Insertion Force: 140 Grams ± 10
- Withdrawal Force: 75 Grams ± 5

### MATERIAL:

Insulator: Glass-fiber P.B.T. (UL94V-0)

Contact: Phosphor bronze, Tin plated.  
(Gold plated is available)

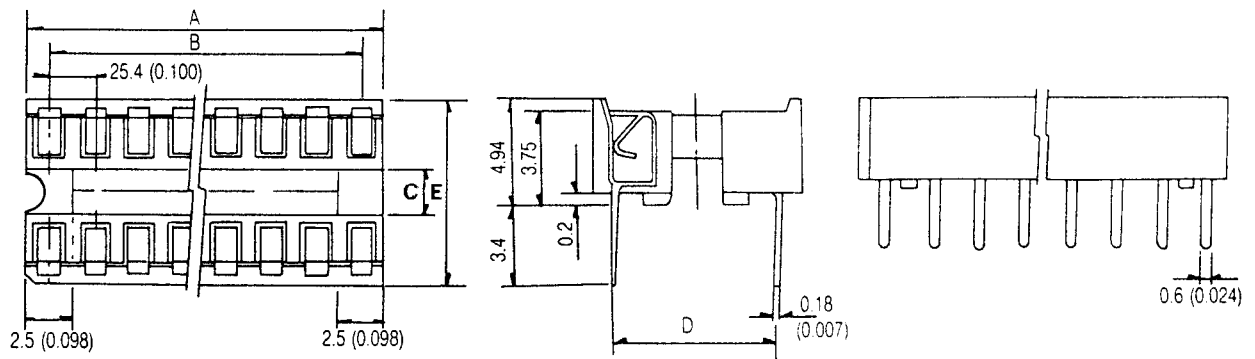
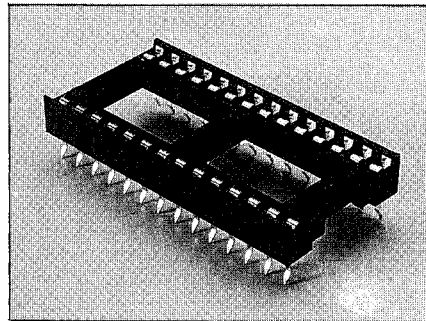
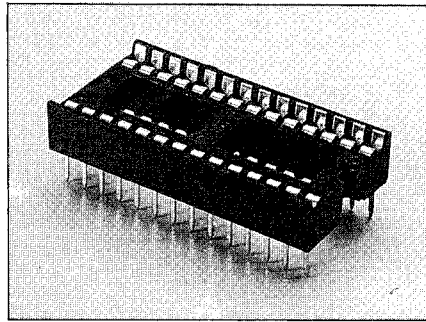

CONTACT TIN PLATING

### DIMENSIONS

	SCS									SCL							
	6P	8P	14P	16P	18P	20P	22P	24P	28P	24P	28P	32P	36P	38P	40P	42P	48P
A	7.52	10.06	17.68	20.05	22.76	25.26	27.80	30.30	35.48	30.38	35.46	40.58	45.55	48.25	50.70	53.27	60.96
B	5.08	7.62	15.24	17.78	20.32	22.86	25.40	27.94	33.02	27.94	33.02	38.10	43.18	45.72	48.26	50.80	58.42
C	C = 9.94									C = 17.6							
D	D = 7.62									D = 15.20							
E	E = 2.36									E = 10.10							