



# SERIES 365

## Terminal Blocks For PC-Boards Stamping Type Insert

Front Wire Inlet Type - Screw On Top  
Spacing 7.5mm or 15mm  
Height Over PC-Board 13mm



365-031-12

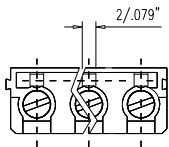
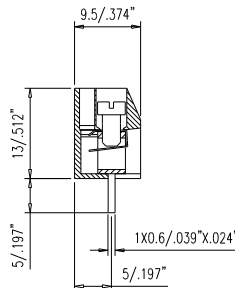
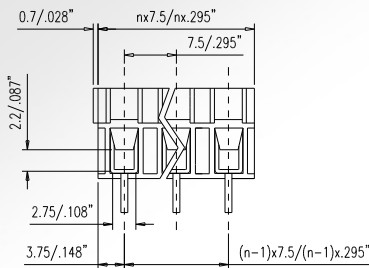

Recommended P.C.B. Holes  
diameter :  $\phi 1.2\text{mm}$  to  $\phi 1.4\text{mm}$   
n= number of contacts

\*\* To avoid accumulated tolerance-variations of Terminal-Blocks to PC-Board spacing, limit the number of contacts to not more than 24 contacts per row.

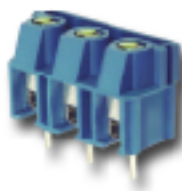

365-031-12

## Technical Data

### Material

- Contact:  
(metal housing)
- Terminal screw:
- Wire guard:
- Surface of solder tail:
- Insulator body  
(housing)

Brass (Cu Zn)  
Cu/Ni, tin plated  
Steel galvanized  
and chromated  
Cu Sn 6

Tin plated  
Poly Butylene  
Terephthlene,  
PBT (30% Glass filled)  
(UL 94 V-0)

### Electrical

- Current rating: 16 Amp
- Resistance to tracking: 5M  $\Omega$
- Dielectric strength: 2500V
- Insulation withstands voltage: AC 1500V/Min
- Rated voltage: 250V
- Rated cross section: 2.5mm<sup>2</sup>
- Rated cross range  
With wire guard: 2.5mm<sup>2</sup>  
Without wire guard: 4.0mm<sup>2</sup>
- Conductor size: 0.5 to 4mm<sup>2</sup>
- AWG: 22 - 14
- Stripping length: 4.5 - 5mm

### Mechanical

- Operating temperature: -30°C to + 120°C
- Short time peak temperature: +200°C max

## HOW TO ORDER :

3	6	5	—	X	X	X	—	X	X
Series No.			No. of Pole		Pitch	Wire Guard		Color	
					1 7.5mm	1 With		1 Grey	
					2 15mm	2 Without		2 Blue	
								3 Black	