

Technical Data

Material (block)

Contact:	Brass (Cu Zn)
(metal housing)	Cu/Ni, tin plated
Terminal screw:	Steel galvanized and chromitized
Wire guard:	Cu Sn 6
Surface of solder tail:	Tin plated
Insulator body: (housing)	Poly butylene Terephthlene- PBT(30% Glass Filled) (UL 94 V-0)

Electrical

Current rating:	16 Amp
Resistance to tracking:	5M Ohm
Dielectric Strength:	2500V
Insulation Withstands	
Voltage:	AC 1500V/Min
Rated Voltage:	300V
Rated cross section:	2.5mm ²
Rated cross range	
With wire guard:	2.5mm ²
Without wire guard:	4.0mm ²
AWG:	22-14

Mechanical

Operating temperatures:	-30°C to +120°C
Short time peak temperature:	+200°C max

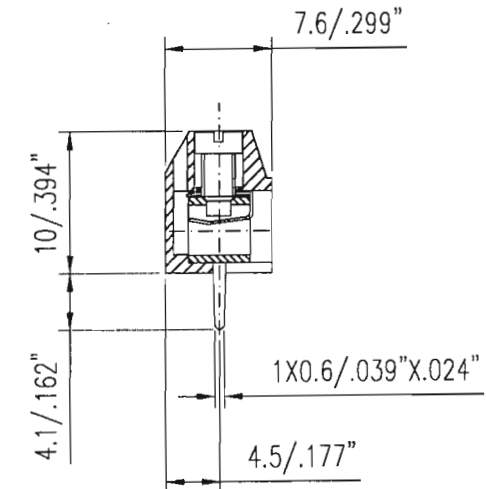
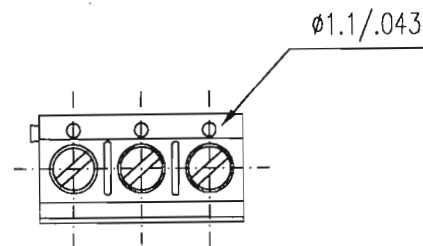
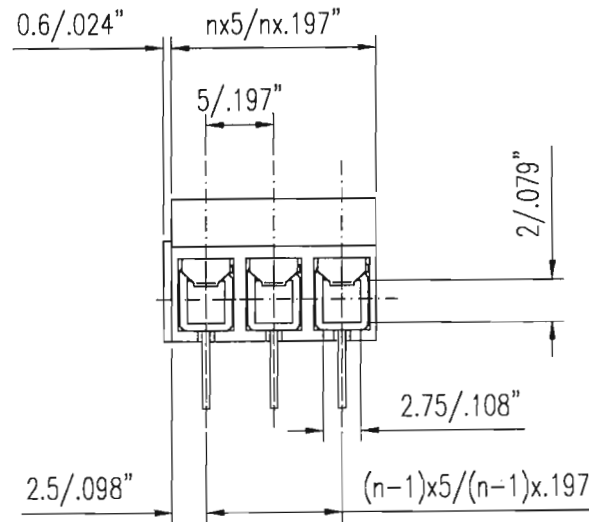

HOW TO ORDER

3	0	6	-	X	X	X	-	X	X
Series No.	No. of Pole	Pitch	Wire Guard	Color					
		1 5MM 2 10MM	1 With 2 Without	1 Grey 2 Blue					

**Notice:

To avoid accumulated tolerance-variations of Terminal-Blocks to PC - Board spacing limit the number of contacts to not more than 24 contacts per row

Recommended PC-Board-Holes diameter: Ø1.2mm to Ø1.4mm
n = number of contacts

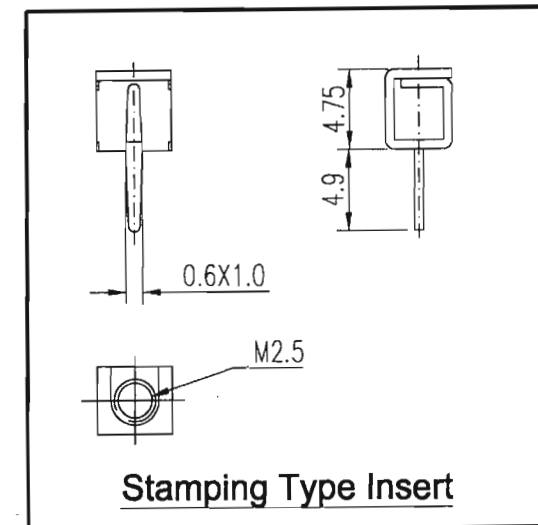

KARSON TECHNOLOGY LIMITED

TITLE: Type 306 Connector

Unit 12,11/F., Vanta Industrial Centre, 21-33 Tai Lin Pai Road, Kwai Chung, N.T., Hong Kong.
Tel : (852) 2421 0833 Fax : (852) 2421 9951
www.karson-tech.com.hk

PART NO. 306-XXX-XX
DWG. NO. KB1257-0

DATE 19 SEP 98
UNIT : MM

SCALE: NTS
DRAWING BY C.L.