



LEDTECH ELECTRONICS CORP.

NANYA ROAD, MUGANG ZHAOQING
CITY GUANGDONG CHINA.

TEL: 86-758-2875541, 2870651, 2877464, 2876185, 2877017

FAX: 86-758-2878014

[Http://www.ledtech.com.tw](http://www.ledtech.com.tw)

SPECIFICATION

PART NO. : LT18W3-86-UCC3-P22

5.0MM ROUND LED LAMP

Approved by	Checked by	Prepared by
<i>San</i>	<i>Jang</i>	<i>Bao Min</i>



5.0MM ROUND LED LAMP
PART NO. : LT18W3-86-UCC3-P22

Features

- * High intensity
- * Reliable and rugged
- * Low current requirement
- * IC compatible

Package Dimensions

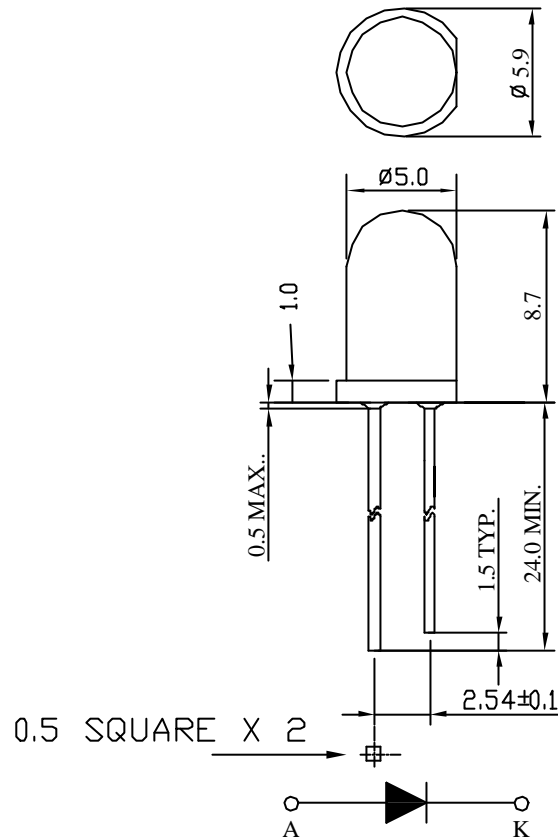

Description

The White lamp are made with InGaN chip and water clear epoxy resin.

Notes:

- 1.All dimensions are in millimeters.
- 2.Tolerance is ± 0.25 mm unless otherwise noted.

Part No.	Led Chip		Lens Color
	Material	Emitting Color	
LT18W3-86-UCC3-P22	InGaN	White	Water clear



5.0MM ROUND LED LAMP

PART NO. : LT18W3-86-UCC3-P22

Page : 2/6

Absolute Maximum Ratings at Ta=25 :

Parameter	Symbol	Rating	Unit
Power Dissipation	Pd	80	mW
Reverse Voltage	Vr	5	V
D.C. Forward Current	If	20	mA
Peak Current (1/10 Duty Cycle , 0.1 ms Pulse Width)	If(Peak)	100	mA
Operating Temperature Range	Topr	-25 to +85	
Storage Temperature Range	Tstg	-40 to +100	
Lead Soldering Temp.(1.6mm from body) for 5 seconds		260	
Electrostatic discharge (ESD)		300	V

Electrical and Optical Characteristics :

Parameter	Symbol	Condition	Min.	Typ.	Max.	Unit
Luminous Intensity	Iv	If=20mA	2100	3500		mcd
Forward Voltage	Vf	If=20mA		3.2	4.0	V
CIE Chromaticity coordinates : X Axis	X	If=20mA		0.290		
CIE Chromaticity coordinates : Y Axis	Y	If=20mA		0.300		
Reverse Current	Ir	Vr=5V			50	μ A
Viewing Angle	2 1/2	If=20mA		25		deg



5.0MM ROUND LED LAMP
PART NO. : LT18W3-86-UCC3-P22

Typical Electrical/Optical Characteristic Curves
 (25 Ambient Temperature Unless Otherwise Noted)

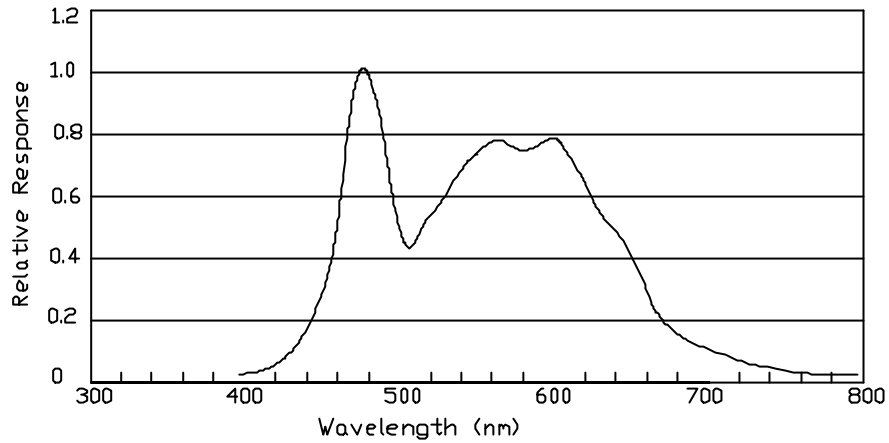
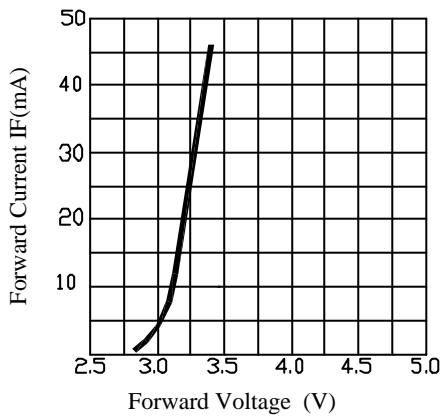
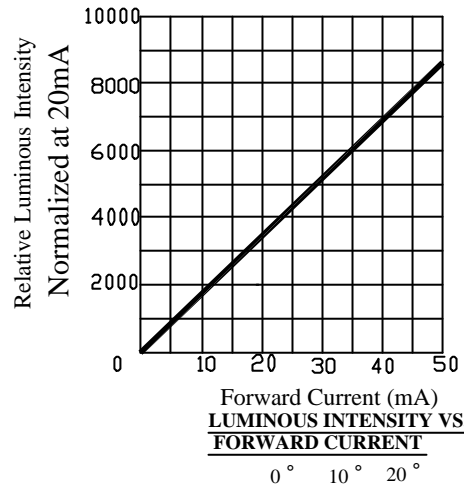

Fig.1 WHITE LED Spectrum VS. WAVELENGTH



FORWARD CURRENT VS. APPLIED VOLTAGE



LUMINOUS INTENSITY VS. FORWARD CURRENT
 0° 10° 20°

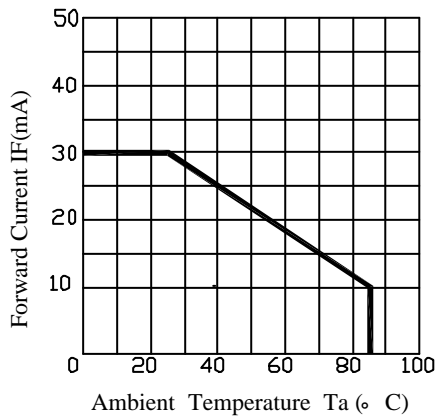

FORWARD CURRENT VS. AMBIENT TEMPERATURE

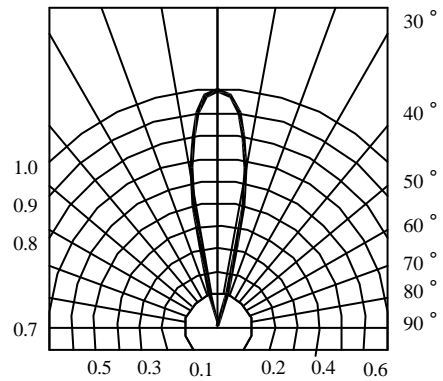

RELATIVE INTENSITY VS. WAVELENGTH



5.0MM ROUND LED LAMP
PART NO. : LT18W3-86-UCC3-P22

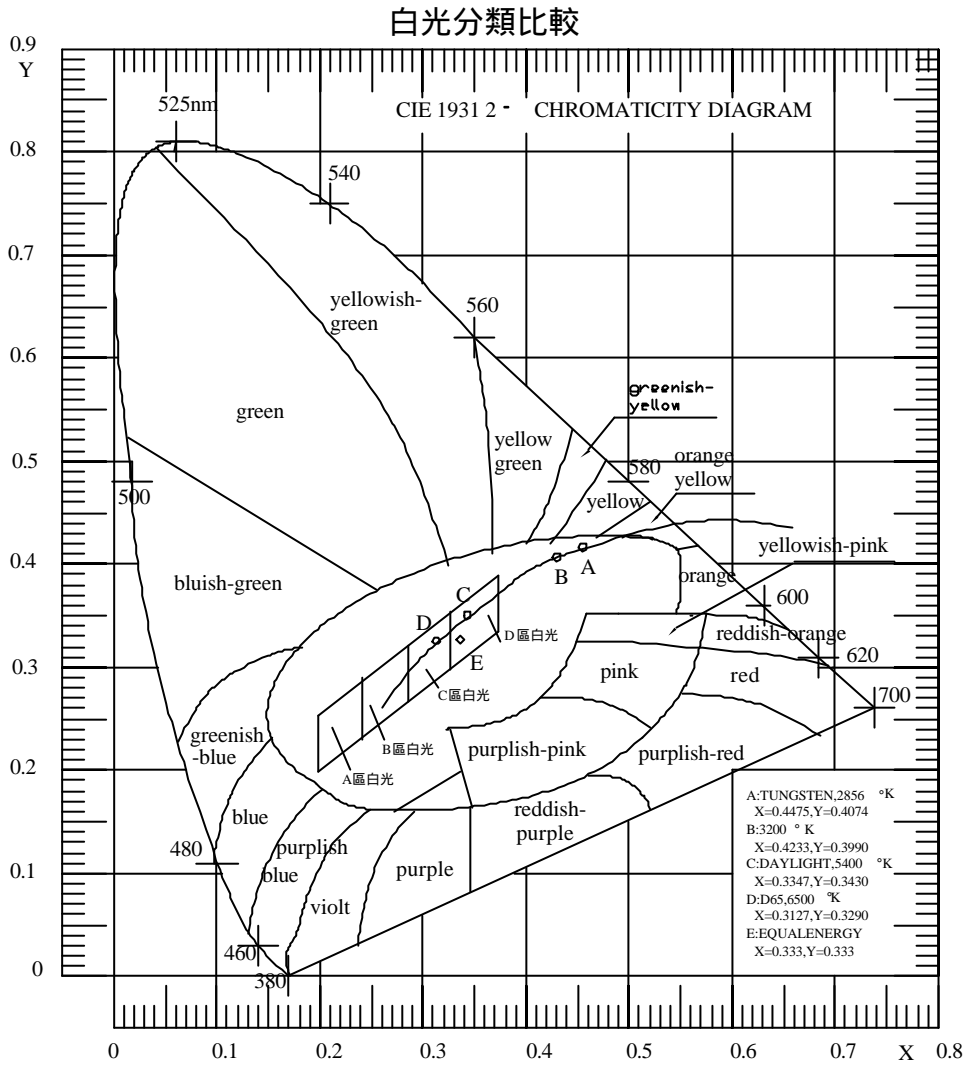

Rank	Chromaticity Coordinates(Ledtech Preliminary)				
A	X	0.22	0.22	0.26	0.26
	Y	0.22	0.28	0.31	0.25
B	X	0.26	0.26	0.29	0.29
	Y	0.25	0.31	0.33	0.27
C	X	0.29	0.29	0.32	0.32
	Y	0.27	0.33	0.35	0.29
D	X	0.32	0.32	0.36	0.36
	Y	0.29	0.35	0.38	0.32
Tolerance	X= ±0.02		Y= ±0.02		



**5.0MM ROUND LED LAMP
PART NO. : LT18W3-86-UCC3-P22**

Reliability Test Method :

Test Item	Test Condition	Duration Time
Operation Life	If=20mA / Ta=25	168hrs
Storage at High Temperature	Ta=100	168hrs
Storage at Low Temperature	Ta=-40	168hrs
Storage at High Temperature/High Humidity	Ta=85 /RH=85 %	168hrs
Operating at High Temperature	Ta=85 / If=20mA	168hrs
Operating at Low Temperature	Ta=-25 / If=20mA	168hrs
Thermal Shock	Ta/T=100 /30min~ -40 /30min	10 cycles
Solderability	Tsol=230	5 sec

Criteria for Judging The Damage:

Item	Symbol	Test Condition	Criteria for Judgment	
			Min.	Max.
Forward Voltage	Vf	If=20mA	-----	Initial Data x1.1
Reverse Current	Ir	Vr=5V	-----	50 μ A
Luminous Intensity	Iv	If=20mA	Initial Data x0.8	-----



5.0MM ROUND LED LAMP
PART NO. : LT18W3-86-UCC3-P22

ENCASED TYPE

PLASTIC PACKAGE
 QUANTITY: 200 PCS

LEDTECH ELECTRONICS CORP.					
PART NO :LTXXXX-XX					
QTY	: PCS				
LOT NO	:XXXXXXXXXX				
DATE	:				
BIN CODE:					

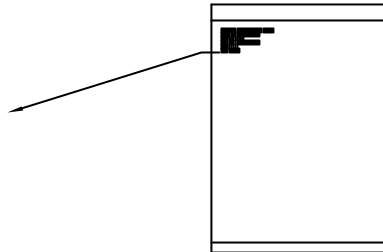

INNER BOX
 QUANTITY: 40 PACKETS
 TOTAL: 8,000 PCS

PART NO.	LXXXXX-XX-XX				
LOT NO.	XXXXXXXXXX				
BIN CODE	Xx X	Xx X	Xx X	Xx X	TOTAL
QUANTITY	PCS	PCS	PCS	PCS	PCS
DATE	XXXX , XX , XX				

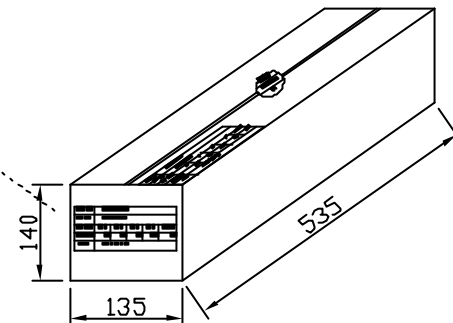

OUTER CARTON
 QUANTITY: 4 BOX
 TOTAL: 32,000 PCS

C/T NO. 箱號	XX
PART NO. 料號	LXXXXX-XX-XX
QUANTITY 數量	PCS
NW 淨重	KGS
GW 毛重	KGS
REMARK 備註	

