

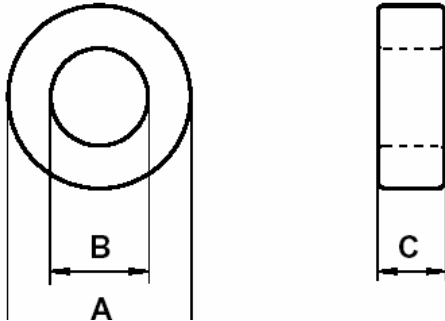

0077310A7

110 Delta Drive
 Pittsburgh, PA 15238
 Phone: 412/696-1333
 Fax: 412/696-0333
 Email:magnetics@spang.com



Core Markings

XXXXXX lot number
 77310A7 part number
 X inductance

DIMENSIONS		
(mm)	Uncoated	Coated
O.D. (A)	22.9	23.6
I.D. (B)	14.0	13.34
Ht. (C)	7.62	8.38

PHYSICAL CHARACTERISTICS					
W _A Window Area	A _e Cross Section	L _e Path Length	V _e Volume	Weight	Box Quantity
141.0 mm ²	31.7mm ²	56.7 mm	1,800 mm ³	11.5 grams	1,000 pieces

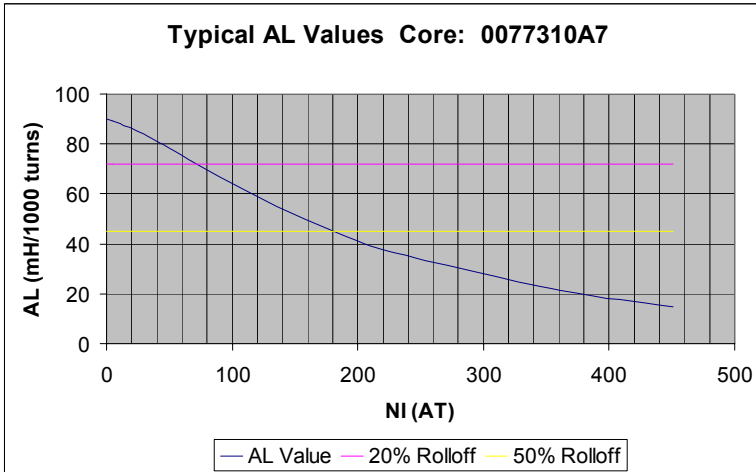

Permeability (μ) **125**

A_L ± 8% **90**

Winding Turn Length	
Winding Factor	Length/Turn (cm)
100% (Unity)	4.29
60%	3.67
40%	3.07
20%	2.80
0%	2.70

Wound Coil Dimensions	
Maximum O.D. (u.w.f.)*	32.6 mm
Maximum HT. (u.w.f.)*	19.8 mm

*u.w.f. – unity winding factor

Surface Area	
Unwound Core	15.7 cm ²
40% Winding Factor	23.8 cm ²

AWG Wire Size	Single Layer Turns	Single Layer Rdc (Ohms, Ω)	AWG Wire Size	Single Layer Turns	Single Layer Rdc (Ohms, Ω)
10	12	0.00106	20	44	0.0395
11	14	0.00156	21	50	0.0565
12	16	0.00226	22	56	0.0804
13	18	0.0032	23	63	0.113
14	21	0.0047	24	71	0.161
15	24	0.00676	25	80	0.229
16	27	0.00961	26	89	0.324
17	31	0.0138	27	99	0.45
18	35	0.0198	28	111	0.642
19	39	0.0278	29	124	0.892