

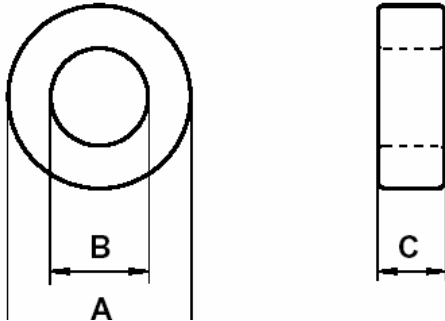

**0077439A7**

110 Delta Drive  
 Pittsburgh, PA 15238  
 Phone: 412/696-1333  
 Fax: 412/696-0333  
 Email:magnetics@spang.com



**Core Markings**  
 XXXXXX  
 0077439A7  
 lot number part number

X  
 inductance

DIMENSIONS		
(mm)	Uncoated	Coated
O.D. (A)	46.7	47.6
I.D. (B)	24.1	23.3
Ht. (C)	18.0	18.92

PHYSICAL CHARACTERISTICS					
W <sub>A</sub> Window Area	A <sub>e</sub> Cross Section	L <sub>e</sub> Path Length	V <sub>e</sub> Volume	Weight	Box Quantity
427.0 mm <sup>2</sup>	199.0 mm <sup>2</sup>	107.4 mm	21,300 mm <sup>3</sup>	131.4 grams	105 pieces

Typical AL Values Core: 0077439A7

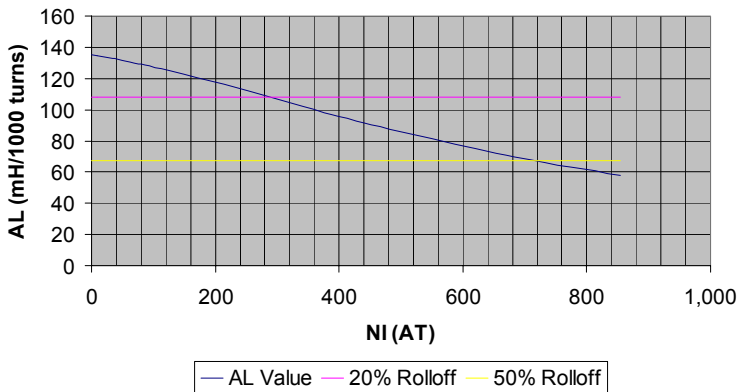

Permeability ( $\mu$ )      **60**

A<sub>L</sub> ± 8%                      **135**

Winding Turn Length	
Winding Factor	Length/Turn (cm)
100% (Unity)	8.66
60%	7.71
40%	6.78
20%	6.37
0%	6.22

Wound Coil Dimensions	
Maximum O.D. (u.w.f.)*	63.8
Maximum HT. (u.w.f.)*	38.7

\*u.w.f. – unity winding factor

Surface Area	
Unwound Core	69.3
40% Winding Factor	94.3

AWG Wire Size	Single Layer Turns	Single Layer Rdc (Ohms, $\Omega$ )	AWG Wire Size	Single Layer Turns	Single Layer Rdc (Ohms, $\Omega$ )
8	18	0.00231	18	63	0.0821
9	21	0.00339	19	71	0.116
10	24	0.0049	20	80	0.166
11	27	0.00694	21	90	0.236
12	31	0.01	22	101	0.334
13	35	0.0143	23	112	0.464
14	39	0.0201	24	126	0.66
15	44	0.0285	25	141	0.932
16	50	0.041	26	158	1.32
17	56	0.0577	27	175	1.83