

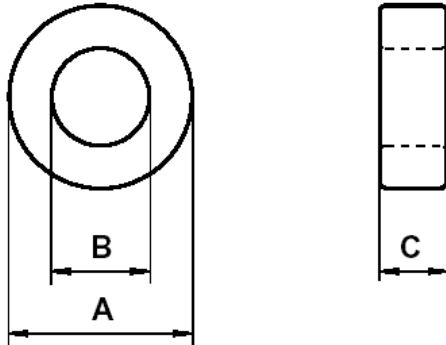

Specification for:  
**YP-41003-TC**

111 Zeta Drive  
Pittsburgh, PA 15238  
Phone: 412/696-1333  
Fax: 412/696-0333  
Email:magnetics@spang.com

**DIMENSIONS**



(mm)	Uncoated Nominal:	Coated Min:	Coated Max:
O.D. (A)	9.53	9.2	9.86
I.D. (B)	4.75	4.42	5.08
Ht. (C)	3.18	2.98	3.38

Eff. Parameters		
A <sub>e</sub> mm <sup>2</sup>	l <sub>e</sub> mm	V <sub>e</sub> mm <sup>3</sup>
7.3	20.7	151

**INDUCTANCE**

AL value (nH/T <sup>2</sup> )	Test conditions
1095 ± 25%	10 kHz, 0.5 mT (For N = 5, use 0.4 mA), 25°C

**CORE LOSSES**

P <sub>L</sub> max	Production lot limit Max avg	Test conditions
18.6 mW (123 mW/cm <sup>3</sup> )	16.9 mW (112 mW/cm <sup>3</sup> )	100 kHz, 100 mT, 100°C
-	-	-

**COATING**

Parylene rated for 130°C continuous operation.
Voltage breakdown rating 1000 V Min Wire-to-Wire.

**NOTE**

Spec. Modifications	Previous	Revised
2005.06.07	Losses: General P material	Losses: Detail as indicated