

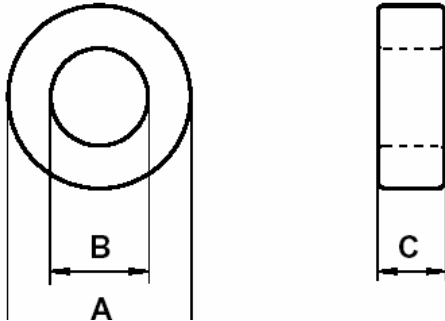

**0077083A7**

110 Delta Drive  
 Pittsburgh, PA 15238  
 Phone: 412/696-1333  
 Fax: 412/696-0333  
 Email:magnetics@spang.com



**Core Markings**

XXXXXX lot number  
 77083A7 part number  
 X inductance

DIMENSIONS		
(mm)	Uncoated	Coated
O.D. (A)	39.9	40.8
I.D. (B)	24.1	23.3
Ht. (C)	14.5	15.37

PHYSICAL CHARACTERISTICS					
W <sub>A</sub> Window Area	A <sub>e</sub> Cross Section	L <sub>e</sub> Path Length	V <sub>e</sub> Volume	Weight	Box Quantity
427.0 mm <sup>2</sup>	107.2 mm <sup>2</sup>	98.4 mm	10,500 mm <sup>3</sup>	64.9 grams	180 pieces

Typical AL Values Core: 0077083A7

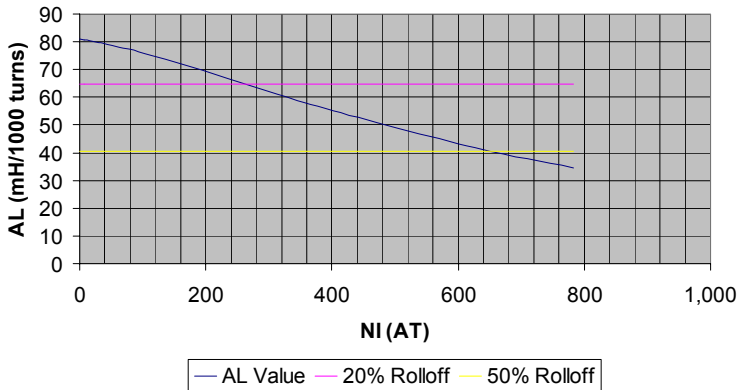

Permeability ( $\mu$ )      **60**

A<sub>L</sub> ± 8%                      **81**

Winding Turn Length	
Winding Factor	Length/Turn (cm)
100% (Unity)	7.38
60%	6.38
40%	5.40
20%	4.97
0%	4.81

Wound Coil Dimensions	
Maximum O.D. (u.w.f.)*	56.4 mm
Maximum HT. (u.w.f.)*	35.2 mm

\*u.w.f. – unity winding factor

Surface Area	
Unwound Core	48.4 cm <sup>2</sup>
40% Winding Factor	71.7 cm <sup>2</sup>

AWG Wire Size	Single Layer Turns	Single Layer Rdc (Ohms, $\Omega$ )	AWG Wire Size	Single Layer Turns	Single Layer Rdc (Ohms, $\Omega$ )
8	18	0.00179	18	63	0.0636
9	21	0.00263	19	71	0.0902
10	24	0.00378	20	80	0.128
11	27	0.00537	21	90	0.182
12	31	0.00778	22	101	0.259
13	35	0.0111	23	112	0.359
14	39	0.0155	24	126	0.511
15	44	0.0221	25	141	0.721
16	50	0.0317	26	158	1.02
17	56	0.0446	27	175	1.42