

■ 徑向引線陶瓷電容特性 FEATURES

- 容量大, 溫度特性, 工作電壓和容量誤差範圍
- 工業生產標準尺寸
- 適合自動安裝的卷帶包裝
- 多種腳形產品
- Wide capacitance, TC, voltage and tolerance range
- Industry Standard sizes
- Tape and reel available for auto placement
- Various lead spacing available

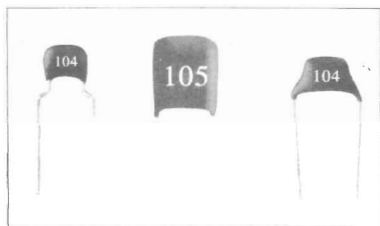

分類選擇 CAPACITOR SELECTION (see P<sub>1</sub>)

介質性能介紹 GENERAL SPECIFICATIONS (see P<sub>2</sub>-P<sub>14</sub>)

■ 訂貨方式 HOW TO ORDER

CC <sub>1</sub>	0805	CG	102	K	500	F
CC <sub>1</sub> : 1類徑向引線電容器 Class I Radial leads MLCC	尺寸規格: 長 × 寬 × 高 (mm) Size code: inches	介質種類 Dielectric	標稱容量 (PF) Nominal Capacitance	誤差 Tolerance	額定電壓 Rated Voltage	包裝方式 Packing Style
CT <sub>1</sub> : 2類徑向引線電容器 Class II Radial leads MLCC	0805 0.08 × 0.05 1206 0.12 × 0.06 1210 0.12 × 0.10 1812 0.18 × 0.12 2225 0.22 × 0.25 3035 0.30 × 0.35	CG COG(NPO) B X7R F Y5V E Z5U	102 10 × 10 <sup>2</sup> 5R0 5.0	B ±0.10PF C ±0.25PF D ±0.5PF F ±1.0K G ±2.0K J ±5.0K K ±10K M ±20K S +50~-20K Z +80~-20V P +100%~-0	160 18 × 10 <sup>2</sup> 250 25 × 10 <sup>2</sup> 500 50 × 10 <sup>2</sup> 630 63 × 10 <sup>2</sup> 101 10 × 10 <sup>2</sup> 201 20 × 10 <sup>2</sup> 501 50 × 10 <sup>2</sup> 102 10 × 10 <sup>2</sup> 202 20 × 10 <sup>2</sup>	包裝方式: Through Hole 卷帶包裝 Ammo 卷帶包裝 Reel 數字包裝 (Bulk-wrap) F <sub>1</sub> 2.5 F <sub>2</sub> 4.0 F <sub>3</sub> 5.0 F <sub>4</sub> 7.0 F <sub>5</sub> 3.5

■ 尺寸, 容量, 工作電壓關係表 SIZE CODE CAPACITANCE AND VOLTAGE

尺寸規格 Size Code	外形 Profile	Dimensions (mm)			工作電壓 Voltage	容量範圍 Capacitance (PF)												
		F(±0.5)	H(min)(±t)	Lmax		Wmax	Tmax	COG(NPO)	X7R	Y5V/Z5U								
0805	a	2.54	5.0	4.2	3.8	3.8	25V	OR5-332-221-105	103-105	103-684								
	b	2.54	10.0															
	c <sub>1</sub>	5.08	5.0 10.0															
	c <sub>2</sub>	5.08	5.0															
	c <sub>3</sub>	5.08	5.0 10.0															
1206	a	2.54	10.0	5.0	4.5	3.8	25V	OR5-682	102-105	103-125								
	b	3.50									10.0	7.6	5.5	3.8	25V	OR5-472	102-105	103-105
	c <sub>1</sub>	5.08																
1210	a	3.50	10.0	7.6	5.5	3.8	25V	OR5-103	102-334	104-155								
	b	3.50									10.0	8.5	8.5	3.8	25V	OR5-102	102-105	104-155
	c <sub>1</sub>	5.08																
1812	a	4.75	10.0	8.5	8.5	3.8	25V	OR5-153	103-474	154-305								
	b	4.75									10.0	10.5	9.5	4.2	25V	OR5-102	103-334	154-325
	c <sub>1</sub>	5.08																
2225	a	5.50	10.0	10.5	9.5	4.2	25V	OR5-223	103-105	684-475								
	b	5.50									10.0	10.5	9.5	4.2	25V	OR5-102	103-334	684-339
	c <sub>1</sub>	5.08																
3035	a	7.50	10.0	12.5	10.5	4.2	25V	OR5-102	103-225	105-105								
	b	7.50									10.0	12.5	10.5	4.2	25V	OR5-102	103-225	105-685
	c <sub>1</sub>	5.08																

**■ 包裝形式 PACKAGING STYLE**

- 盒帶包裝 Ammo package

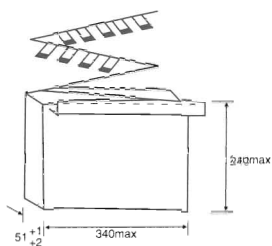
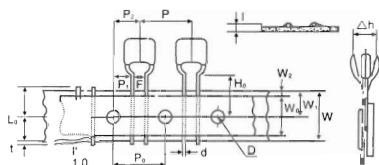

代號 Code	P <sub>0</sub>	P <sub>1</sub>	P <sub>2</sub>	d	Δh	W	W <sub>0</sub>	W <sub>1</sub>	W <sub>2</sub>	H <sub>0</sub>	i	D	t	L <sub>0</sub>
尺寸 Dim	±2.7	★ $\frac{3.81}{5.08}$	6.35	0.5	0	18	5	9	3.0	16-21	1.5	4.0	1.0	11
誤差 Tol.	±0.3	±0.7	±0.7	±0.1	$\pm 0.1$ max	+1 -0.5	min	+0.75 -0.5	MAX	±0.5	MAX	±0.2	MAX	MAX

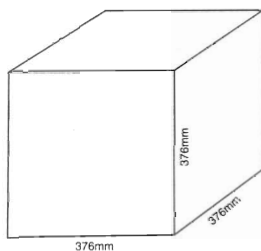
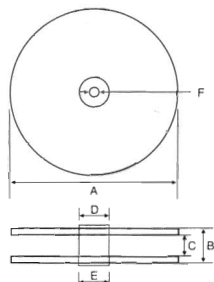

- 卷盒包裝 Reel Package

單位(mm) Dimensional(mm)

A	B	C	D	E	F
355-365	50.8 max	38.10-46.02	102.01 max	86.36 max	25.40-30.48

**■ 包裝數量 PACKAGING QUANTITY**

盒帶包裝 Ammo package	卷盒包裝 Reel Package	散包裝 Bulk Package
2500	4000	1000.500

\* 可根據用戶需要包裝。

\* 注：2.54mm腳距 P1=5.1±0.7

5.08mm腳距 P1=3.75±0.7