

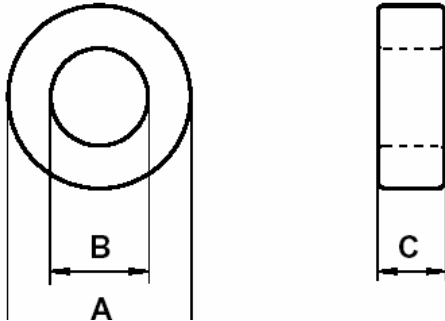

**0077206A7**

110 Delta Drive  
 Pittsburgh, PA 15238  
 Phone: 412/696-1333  
 Fax: 412/696-0333  
 Email:magnetics@spang.com



**Core Markings**

XXXXXX lot number  
 77206A7 part number  
 X inductance

DIMENSIONS		
(mm)	Uncoated	Coated
O.D. (A)	20.3	21.1
I.D. (B)	12.7	12.07
Ht. (C)	6.35	7.11

PHYSICAL CHARACTERISTICS					
W <sub>A</sub> Window Area	A <sub>e</sub> Cross Section	L <sub>e</sub> Path Length	V <sub>e</sub> Volume	Weight	Box Quantity
114.0 mm <sup>2</sup>	22.1 mm <sup>2</sup>	50.9 mm	1,120 mm <sup>3</sup>	7.1 grams	1,600 pieces

Typical AL Values Core: 0077206A7

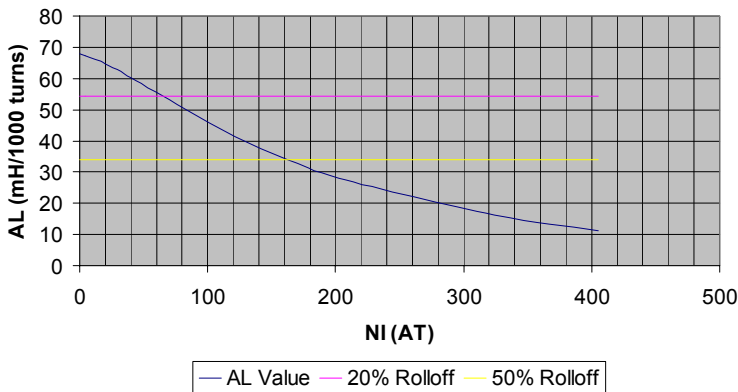

Permeability ( $\mu$ )      125

A<sub>L</sub> ± 8%                      68

Winding Turn Length	
Winding Factor	Length/Turn (cm)
100% (Unity)	3.67
60%	3.15
40%	2.64
20%	2.41
0%	2.33

Wound Coil Dimensions	
Maximum O.D. (u.w.f.)*	29.2 mm
Maximum HT. (u.w.f.)*	17.4 mm

\*u.w.f. – unity winding factor

Surface Area	
Unwound Core	12.1 cm <sup>2</sup>
40% Winding Factor	18.9 cm <sup>2</sup>

AWG Wire Size	Single Layer Turns	Single Layer Rdc (Ohms, Ω)	AWG Wire Size	Single Layer Turns	Single Layer Rdc (Ohms, Ω)
11	12	0.001354	21	45	0.0439
12	14	0.0017	22	50	0.0618
13	16	0.00245	23	56	0.0867
14	18	0.00347	24	63	0.124
15	21	0.0051	25	71	0.176
16	24	0.00736	26	80	0.25
17	27	0.0104	27	89	0.349
18	31	0.0151	28	100	0.498
19	35	0.0215	29	111	0.688
20	39	0.0301	30	125	0.992