



LT3KX1-81

9.6MM ROUND LAMP

Features

- * ULTRABRIGHT RED
- * HIGH LIGHT OUTPUT
- * RELIABLE AND RUGGED
- * IC COMPATIBLE

Absolute Maximum Ratings at T_A=25°C

REVERSE VOLTAGE (<100 μA).....	4.0v
D.C. FORWARD CURRENT.....	30mA
PULSE CURRENT (1 μSEC. PULSE, 0.3% DUTY CYCLE).....	100 mA
OPERATING TEMPERATURE RANGE.....	-25°C TO +85°C
STORAGE TEMPERATURE RANGE.....	-25°C TO +100°C
LEAD SOLDERING TEMP. (1.6mm FROM BODY).....	260°C FOR 5 SEC.

Electrical/optical characteristics at T_A=25°C

PART NUMBER	LED CHIP		LEN'S COLOR	PEAK WAVELENGTH @20 mA (nm)	FORWARD VOLTAGE @20mA(V)		LUMINOUS INTENSITY @20mA(mcd)		VIEW ANGLE 2θ _{1/2} (deg)
	MATERIAL	EMITTING COLOR			TYP.	MAX.	MIN.	TYP.	
LT3K11-81	GaAsP	RED	R.D.	655	1.7	2.0	1.4	2.3	30
LT3K11G-81	GaP	RED	R.D.	700	2.1	3.0	2.0	3.4	30
LT3K21-81	GaP	GREEN	G.D.	567	2.1	3.0	10.0	16.7	30
LT3K31-81	GaAsP ON GaP	YELLOW	Y.D.	585	2.1	3.0	8.2	13.7	30
LT3K41-81	GaAsP ON GaP	ORANGE	O.D.	635	2.1	3.0	11.6	19.4	30
LT3K41R-81	GaAsP ON GaP	HI-EFF RED	R.D.	635	2.1	3.0	11.6	19.4	30

- (1) LEN'S COLOR
 R.D.....RED DIFFUSED
 G.D.....GREEN DIFFUSED
 Y.D.....YELLOW DIFFUSED
 O.D.....ORANGE DIFFUSED

- (2) SPECIFICATIONS ARE SUBJECT TO CHANGE WITHOUT NOTICE.
 (3) ALL ABOVE COMPONENTS ARE CONSIDERED. DEVIATIONS FROM STATED SPECIFICATIONS WILL REQUIRE A NEW PART NUMBER BE ASSIGNED.

Package Dimensions

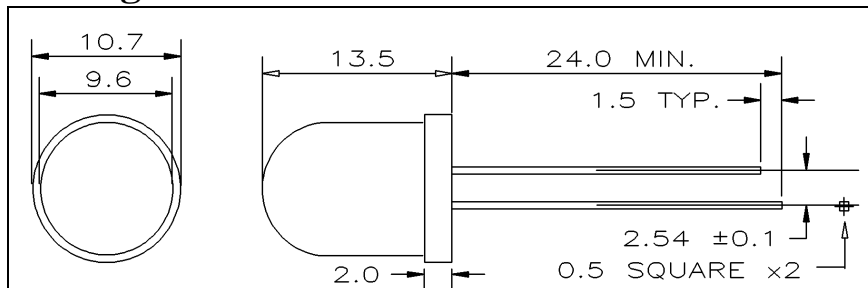

1. ALL DIMENSIONS ARE IN mm, TOLERANCE IS ±0.25mm UNLESS OTHERWISE NOTED.
2. AN EPOXY MENISCUS MAY EXTEND ABOUT 1.0mm DOWN THE LEADS.
3. BURR AROUND BOTTOM OF EPOXY BODY MAY BE 0.5mm MAX.

Radiation Pattern

