

UL
E166099

360-031-12

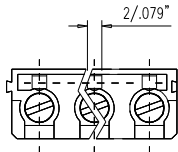
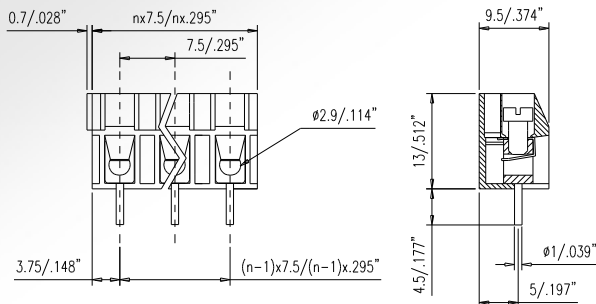

Recommended P.C.B. Holes
 diameter : $\phi 1.2\text{mm}$ to $\phi 1.4\text{mm}$
 n= number of contacts

** To avoid accumulated
 tolerance-variations
 of Terminal-Blocks to
 PC-Board spacing,
 limit the number of
 contacts to not more
 than 24 contacts per row.



360-031-12

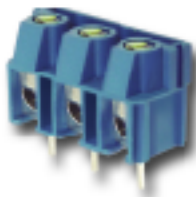

SERIES 360

Terminal Blocks For PC-Boards Machined Type Insert

Front Wire Inlet Type - Screw On Top
 Spacing 7.5mm or 15mm
 Height Over PC-Board 13mm

Technical Data

Material

- Contact:
(metal housing)
 - Terminal screw:
 - Wire guard:
 - Surface
of solder tail:
 - Insulator body:
(housing)
- Brass (Cu Zn)
 Cu/Ni, tin plated
 Steel galvanized
 and chromated
 Cu Sn 6
- Tin plated
 Poly Butylene
 Terephthlene,
 PBT (30% Glass filled)
 (UL 94 V-0)

Electrical

- Current rating:
 - Resistance to tracking:
 - Dielectric strength:
 - Insulation withstands
voltage:
 - Rated voltage:
 - Rated cross section:
 - Rated cross range
With wire guard:
 - Without wire guard:
 - AWG:
 - Stripping length:
- 16 Amp
 5M Ω
 2500V
 AC 1500V/Min
 300V
 2.5mm²
 2.5mm²
 4.0mm²
 22 - 14
 4.5 - 5mm

Mechanical

- Operating
temperature:
 - Short time peak
temperature:
- 30°C to + 120°C
 +200°C max

HOW TO ORDER :

3	6	0	—	X	X	X	—	X	X
Series No.			No. of Pole		Pitch	Wire Guard		Color	
					1 7.5mm	1 With		1 Grey	
					2 15mm	2 Without		2 Blue	
								3 Black	